



Complete GLT Manufacturing Facility

LEDINEK - ENGINEERED TIMBER - GLT PRODUCTION LINE IN AUSTRIA

Complete GLT Manufacturing Facility for A. Baumgartner GmbH in Austria

Company A. Baumgartner GmbH in Austria has invested in new Turnkey industrial production for glue laminated timber. The line is in the commissioning stage and will shortly start to supply the domestic market with glulam beams. Ledinek got the opportunity to supply a complete GLT line.

All machines are integrated under special developed Glulam manager PC based control system.

Company: **A. Baumgartner GmbH**

Location: Sollenau / Austria

Species: spruce, larch, pine

Production capacity: 57.600 m³/y - solid finger jointed timber and 19.200 m³/y glulam beams

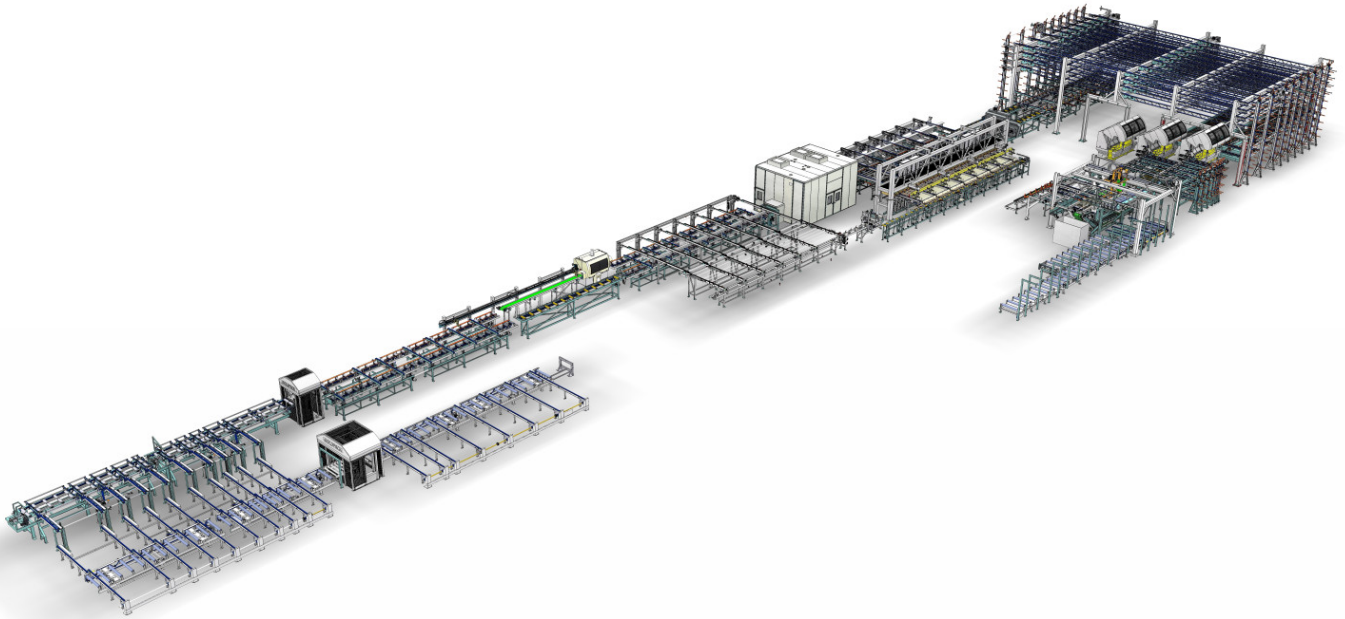

Turnkey GLT production

1. Vacuum de-stacking and device for stacking strips removal with sensor recognition
2. Moisture meter, reject gate
3. Marking station with integrated turning device
4. X-CUT S350 cross cut saw to remove timber defects
5. Pull off with lug chains and alignment roll conveyor to the left/right
6. Infeed system to finger jointing machines
7. Two EUROZINK Compact 6-400 kN
8. Possible upgrade with third EUROZINK Compact
9. In-feed to Multi tray storage
10. Multi tray curing storage (4 trays) with lug chains
11. Conveyor with adjustable stop
12. HTBS 700 horizontal band saw
13. SUPERLES 400 6V+4F-S120 multi side planer in special version
14. Glue application machine with primer application system
15. MAXIPRESS 1000-16 cross transfer press for production of laminated timber, duo and trio beams, ...
16. Reparation station with turning device
17. X-CUT S350 cross cut saw
18. Automatic stretch wrapping machine for single beams
19. Stacking machine
20. Automatic stretch wrapping machine for packages

Facts

- up to 16 m x 0,45 m x 0,32 m beams size
- up to 57.600 m³/year or 120 m³/shift for solid finger jointed timber
- up to 19.200 m³/year or 40 m³/shift for glulam beams
- High flexibility of production

Photo gallery





 [Glulam beam plants product brochure](#)

 [Glue-laminated timber made of Siberian larch](#)

Related products

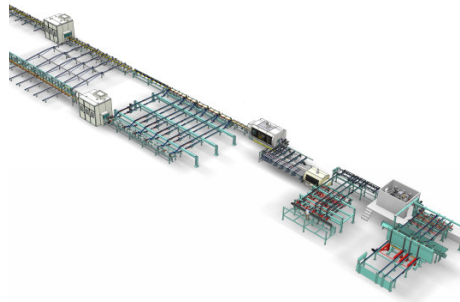
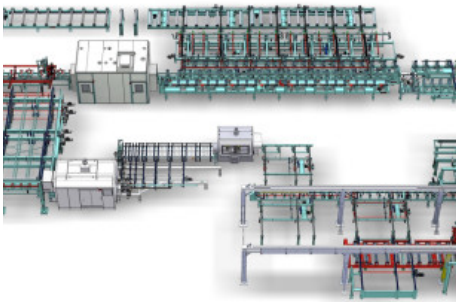

▶ GLT allrounder for customer in Poland

A universal LEDINEK fingerjointing and glulam production line offers the family owned company Odnova from Spytkowice, Poland a perfect tool to serve the local and international markets

▶ Complete GLT Manufacturing Facility for Koles in Slovenia

Company Koles d.o.o. in Slovenia has invested in new Turnkey industrial production for glue laminated timber

▶ GLT UAB JURES MEDIS

Company UAB „JÜRÈS MEDIS“ has invested in a Turnkey industrial production for glue laminated timber.

[MORE](#)

MORE

MORE

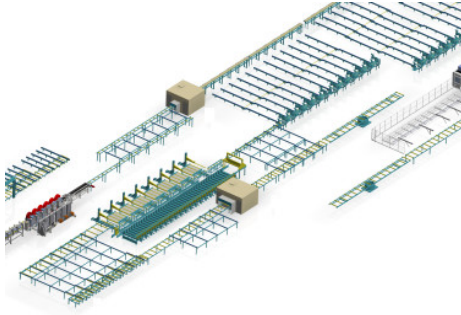

▶ **Glulam line**

Complete solution for production of glue laminated timber

MORE

▶ **Maxipress**

Fast glulam and Duo-/Trio- press with motorized clamping

MORE

▶ **HTBS**

Horizontal band resaw

MORE

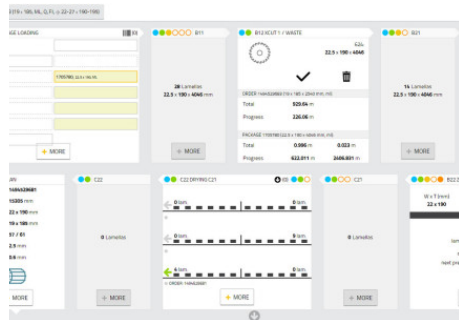
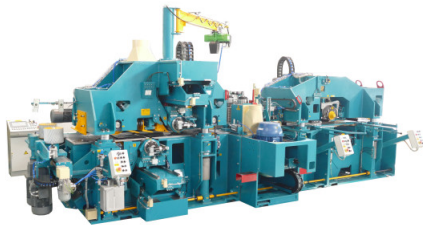

▶ **Superles 400 / 600**

One machine, for the entire production, for the best surface finish. The one and only high capacity beam planer.

MORE

▶ **iLam Manager**

Glulam production management system with high flexibility of the system, makes it suitable for various kinds of glulam productions helps to improve automation and business process flow

MORE