



Complete GLT Manufacturing Facility

LEDINEK - ENGINEERED TIMBER - GLT MOELVEN TÖREBODA

GLT Manufacturing Facility for Moelven in Töreboda

Company **Moelven Töreboda** has invested in a Turnkey industrial production for glue laminated timber. The line went into production 2010 and supply the domestic as well as European market with glulam beams. Ledinek got the opportunity to supply a complete GLT line for customized curved beams.

Company: Moelven AS

Location: Töreboda Sweden

Species: spruce

Production capacity: 40.000 m³/y - glulam beams in 2 shifts operation

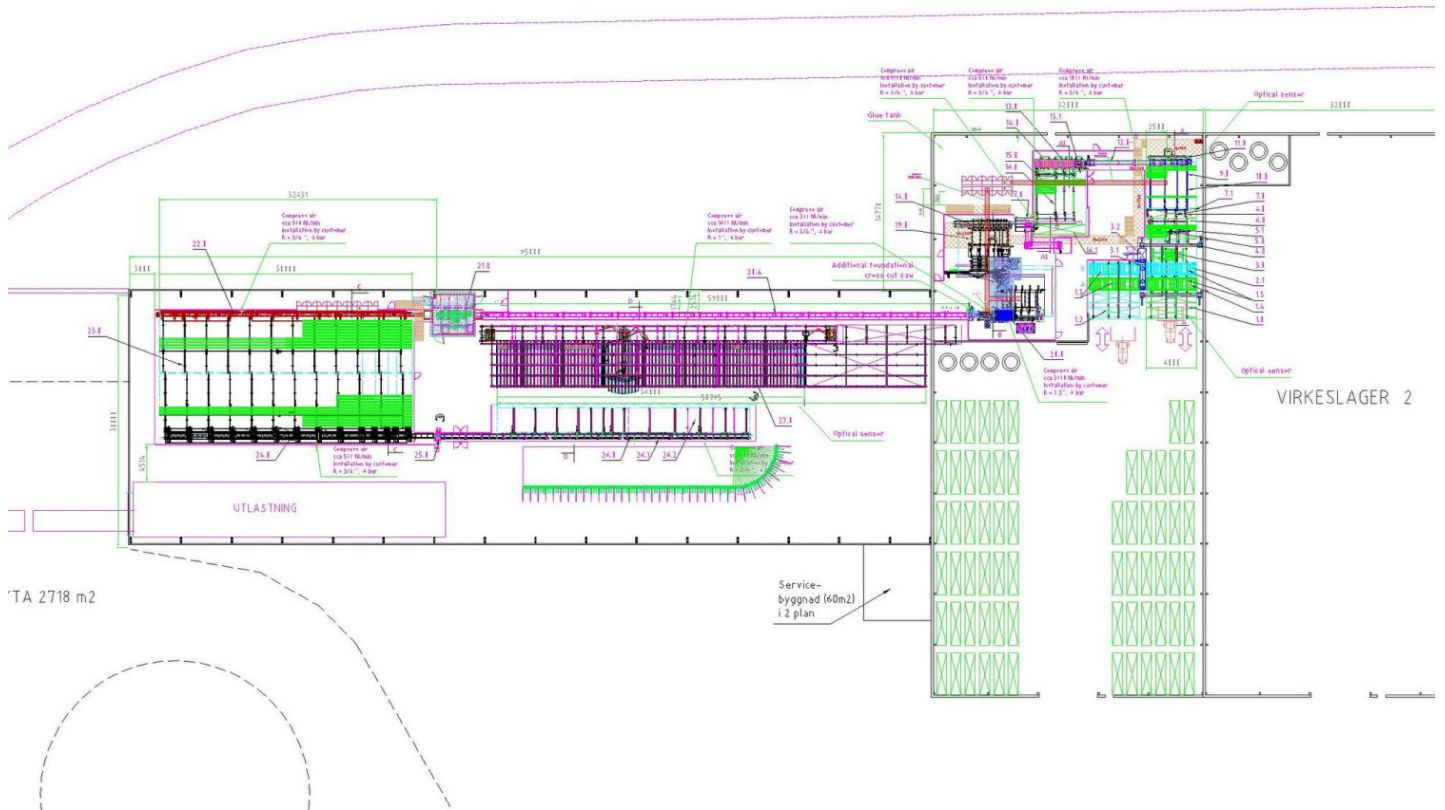

Main machines:

1. Vacuum destacker for 2 qualities
2. Cup detection with turning station
3. Moisture meter with reject gate
4. Manual marking station
5. Buffer decks for A&B quality
6. Optimizing saw X-Cut
7. Finger jointer Kontizink 15 200 kN
8. Lamella planer Rotoles 300 KS-S200
9. Floor storage divided cross and length
10. Glulam Press for straight curved beams Hyperpress 36 m

Facts

- up to 40.000 m³/year or 80 m³/shift for glulam beams
- MUF glue with cold setting
- High flexibility of production

Photo gallery



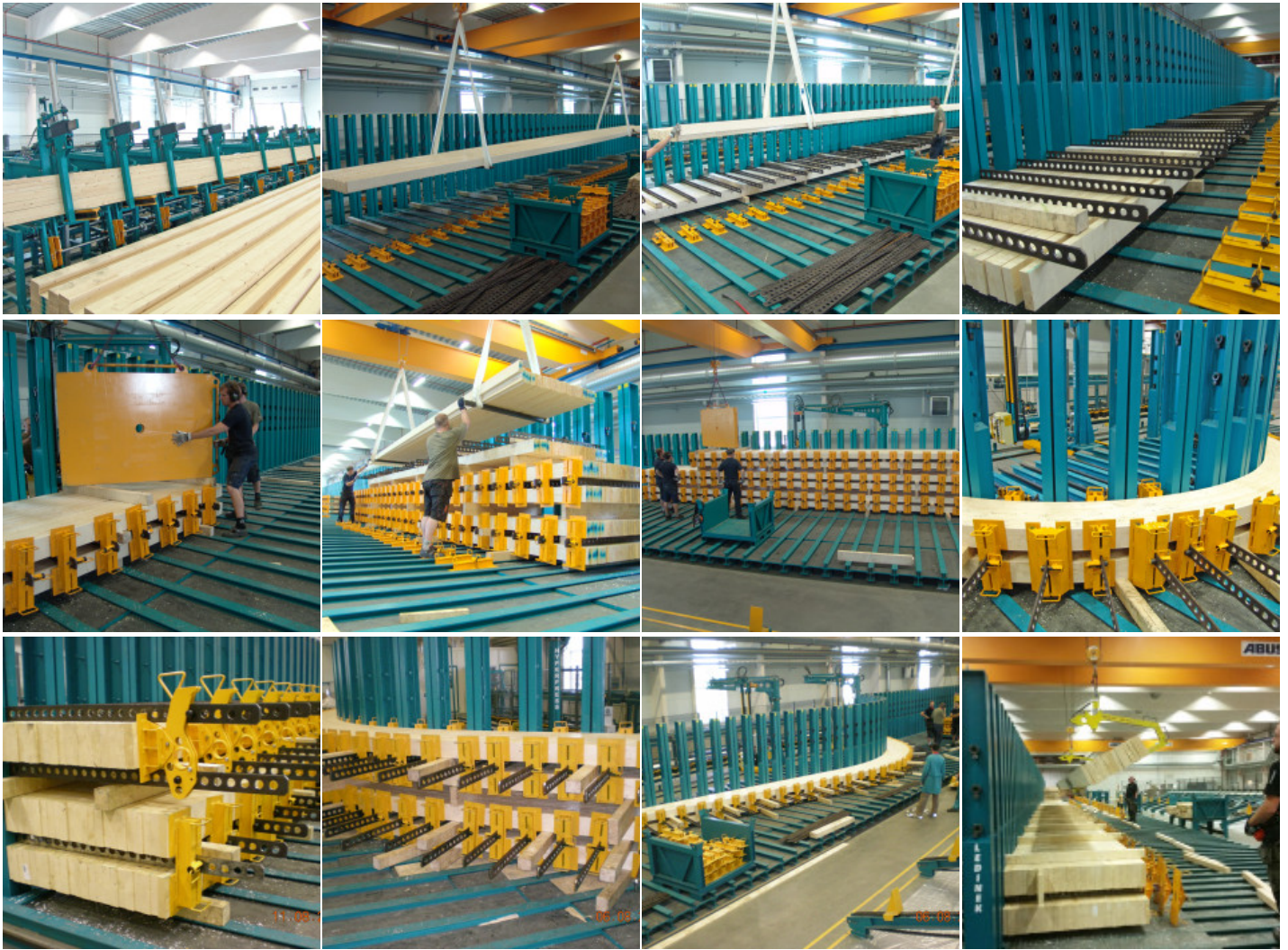

Video Finger jointing line

Video Hyperpress curved beams production

Related products

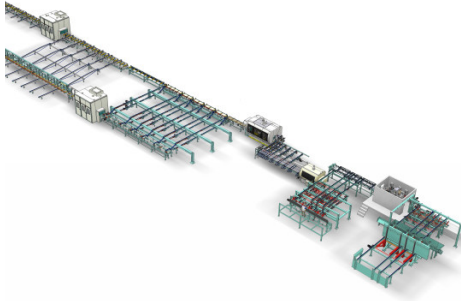

▶ Complete GLT Manufacturing Facility for Koles in Slovenia

Company Koles d.o.o. in Slovenia has invested in new Turnkey industrial production for glue laminated timber

[MORE](#)

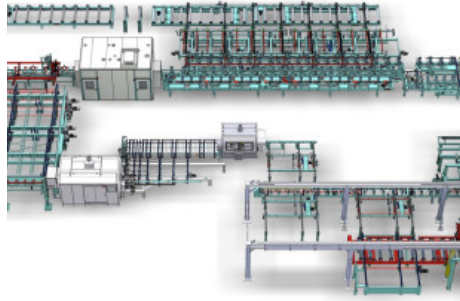

▶ GLT allrounder for customer in Poland

A universal LEDINEK fingerjointing and glulam production line offers the family owned company Odnova from Spytkowice, Poland a perfect tool to serve the local and international markets

[MORE](#)

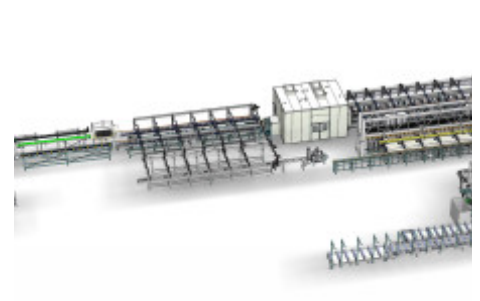

▶ GLT production line in Austria

Company A. Baumgartner GmbH in Austria has invested in new Turnkey industrial production for glue laminated timber.

[MORE](#)



▶ GLT UAB JURES MEDIS

Company UAB „JÜRÉS MEDIS“ has invested in a Turnkey industrial production for glue laminated timber.

[MORE](#)

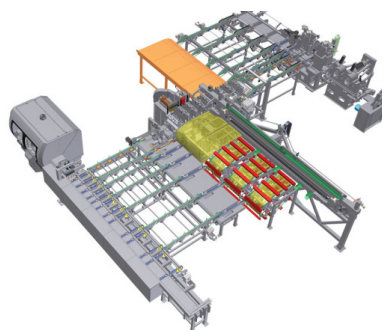

▶ Kontizink 2000

Single piece milling and hydraulic pressing system for solid constructional timber

[MORE](#)

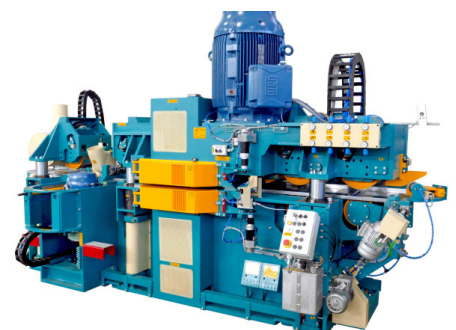

▶ Rotoles S

ROTOLES S milling machines are the best choice for calibration of boards and laminations before gluing.

[MORE](#)



▶ Hyperpress

Curved beam press bed with
automatic positioning

[MORE](#)