

A close-up photograph of a finger jointing machine. The machine's rollers and cutting tools are shown in the process of creating a finger joint in a piece of light-colored wood. The lighting is dramatic, highlighting the texture of the wood and the metallic components of the machine.

Strong and compact

LEDINEK - FINGER JOINTING - EUROZINK COMPACT 900

Eurozink Compact 900

Best finger jointing solution for small and medium sized productions with excellent availability factors. A strong machine for solid construction timber.

This very versatile finger jointing machine boasts a range of innovations. It has reinvented the sector of compact finger jointing machines and still remains its most technologically advanced representative. Strong side alignment, exact positionable feed and hydraulic milling stroke will provide advantages that no other machine can.

Setting of this fully PLC controlled finger jointing machine can be executed in the shortest time, supporting highly adaptable, customer oriented production.

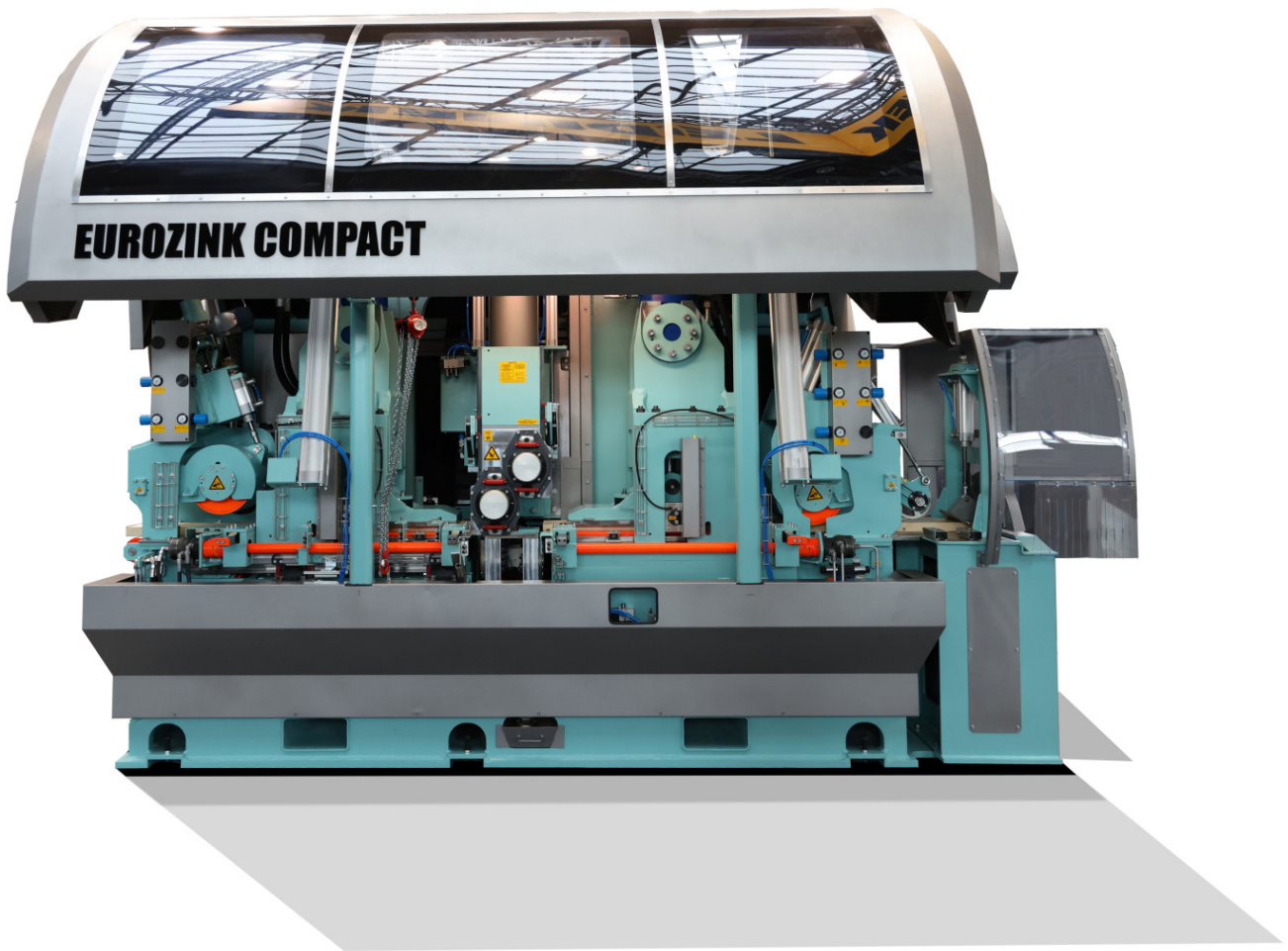

Highlights:

- Fast change of dimension
- Small footprint
- Fully automated machine setup
- High pressing power
- Highest productivity
- Various glue application systems
- Fixed guiding fence
- Strong side pressure
- All machining steps without reclamping
- Fixed cross-cut saw

Benefits of fixed guiding fence

- One side always aligned
- No positioning for width
- All the excess width is planed off on one side
- Easy setting of finger joint cutters and glue applicator
- Less required cutoff on the planer

Technical data

EUROZINK COMPACT 900

 Width	75 - 320 mm
 Thickness	20 - 120 mm
 Cycles	7 1/min
 Typical capacity	900 m/h
 Feeding speed	21 m/min
 Diameter of finger cutters	200 mm

Machine Models

- Eurozink COMPACT 1000

EXTRACTION

FINGER
 JOINTING

Photo gallery



Video

 Ledinek Eurozink Compact product brochure

Related products

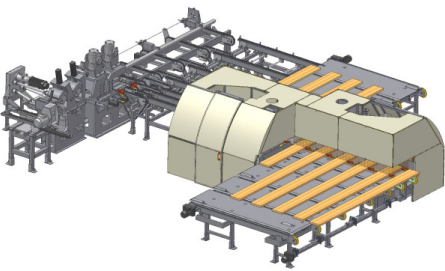

▶ Eurozink 1500

Single piece finger jointing system with high power cycle press for production of solid constructional timber

[MORE](#)

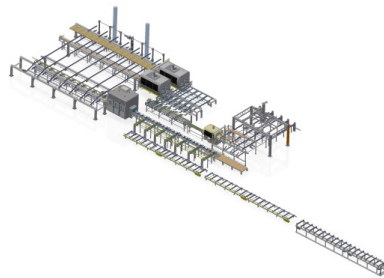

▶ Constructional timber line - 12 joints

Finger jointing production line for solid constructional timber with capacity of 12 joints per minute

[MORE](#)

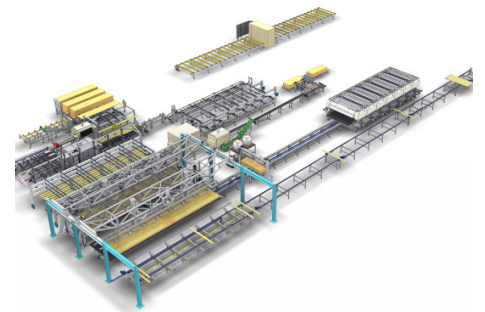

▶ CLT production line Latvia

Complete solution for production of cross laminated timber

[MORE](#)