



# Strong and compact

LEDINEK - FINGER JOINTING - EUROZINK COMPACT 800

## **Eurozink Compact 800**

Best finger jointing solution for small and medium sized productions with excellent availability factors. A strong machine for solid construction timber.

This very versatile finger jointing machine boasts a range of innovations. It has reinvented the sector of compact finger jointing machines and still remains its most technologically advanced representative. Strong side alignment, exact positionable feed and hydraulic milling stroke will provide advantages that no other machine can.

Setting of this fully PLC controlled finger jointing machine can be executed in the shortest time, supporting highly adaptable, customer oriented production.



### Highlights:

- Fast change of dimension
- Small footprint
- Fully automated machine setup
- High pressing power
- Highest productivity
- Various glue application systems
- Fixed guiding fence
- Strong side pressure
- All machining steps without reclamping
- Fixed cross-cut saw

### Benefits of fixed guiding fence

- One side always aligned
- No positioning for width
- All the excess width is planed off on one side
- Easy setting of finger joint cutters and glue applicator
- Less required cutoff on the planer

## Technical data

### EUROZINK COMPACT 800

→← Width

75 - 330 mm

	Thickness	20 - 180 mm
	Cycles	6 1/min
	Typical capacity	800 m/h
	Feeding speed	21 m/min
	Diameter of finger cutters	200 mm

**Machine Models**

- Eurozink COMPACT 800

EXTRACTION

FINGER  
JOINTING

- Eurozink COMPACT K 800

EXTRACTION

FINGER  
JOINTING

**Photo gallery**



**Video**

 Ledinek Eurozink Compact product brochure

## Related products

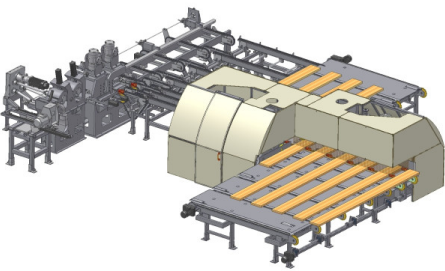

### ▶ Eurozink 1500

Single piece finger jointing system with high power cycle press for production of solid constructional timber

[MORE](#)

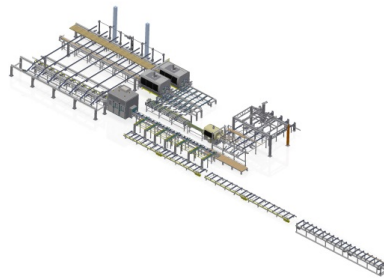

### ▶ Constructional timber line - 12 joints

Finger jointing production line for solid constructional timber with capacity of 12 joints per minute

[MORE](#)

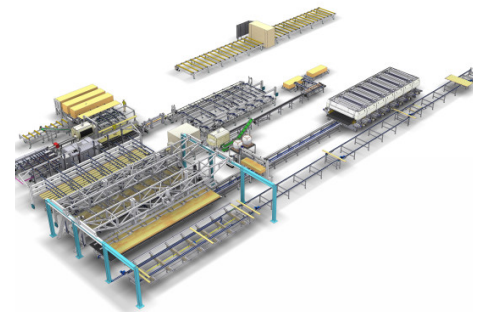

### ▶ CLT production line Latvia

Complete solution for production of cross laminated timber

[MORE](#)