



LEDINEK - ENGINEERED TIMBER - COMPLETE CLT FACILITY INSTALLED AT MOSSE

Complete CLT Facility Installed at Mosser

Mosser Leimholz, a well-established company in Lower Austria's timber industry, has made a significant milestone in their corporate history by engaging in cross-laminated timber production. This strategic move not only underscores their commitment to innovation and quality, but also their confidence in choosing the right partners to achieve their ambitious goals. A key decision in this process was selecting Ledinek as the main equipment supplier for their new production line, a choice marked by deep strategic thinking and a clear understanding of the technological requirements for modern wood processing facilities.

The choice fell on Ledinek, a globally recognized specialist in woodworking machinery known for its custom solutions and the exceptional quality of its equipment. This decision was based not only on Ledinek's technical expertise and the reliability of their machines, but also on the positive experience Mosser Leimholz had previously had with Ledinek in other areas. Ledinek's ability to offer a completely integrated production line, ranging from raw material handling to the finished product, played a crucial role. This complete solution promised an optimized production chain, minimized interface problems, and ensured high efficiency and quality of the end products.

The entire production process was meticulously planned to meet the high standards of Mosser Leimholz. Starting with the precise handling of the lamellas by a vacuum lifter, through the state-of-the-art planing and finger-jointing facilities to the final pressing and surface finishing, each phase of the manufacturing process reflects the pursuit of perfection. Special attention was given to the selection of adhesives and pressing processes, with Mosser consciously opting for 1K-PUR adhesive and cold pressing techniques to meet the demands of modern cross-laminated timber.

Furthermore, the facility allows the production of panels in custom sizes, directly responding to market requirements. The flexibility in production, supported by Ledinek's advanced technology, enables Mosser Leimholz to efficiently serve a wide range of customer needs, from standard sizes to special custom orders.

The collaborative partnership between Mosser Leimholz and Ledinek, marked by mutual trust and the shared vision of

a state-of-the-art CLT production facility, has enabled the realization of a project of exceptional technological and ecological value. The facility, designed for an annual output of 50,000 m³, sets new industry standards and confirms the role of Mosser Leimholz as a pioneer in the processing and finishing of wood products.

Company: Mosser Leimholz GmbH

Website: www: **www.mosser.at**

Location: A-3263 Randegg

Project Manager: Herbert Spahn

Operations Manager: Erich Faffelberger MSc

Employees: 30

Timber species: Spruce

Production Capacity: over 50.000 m³ / Year

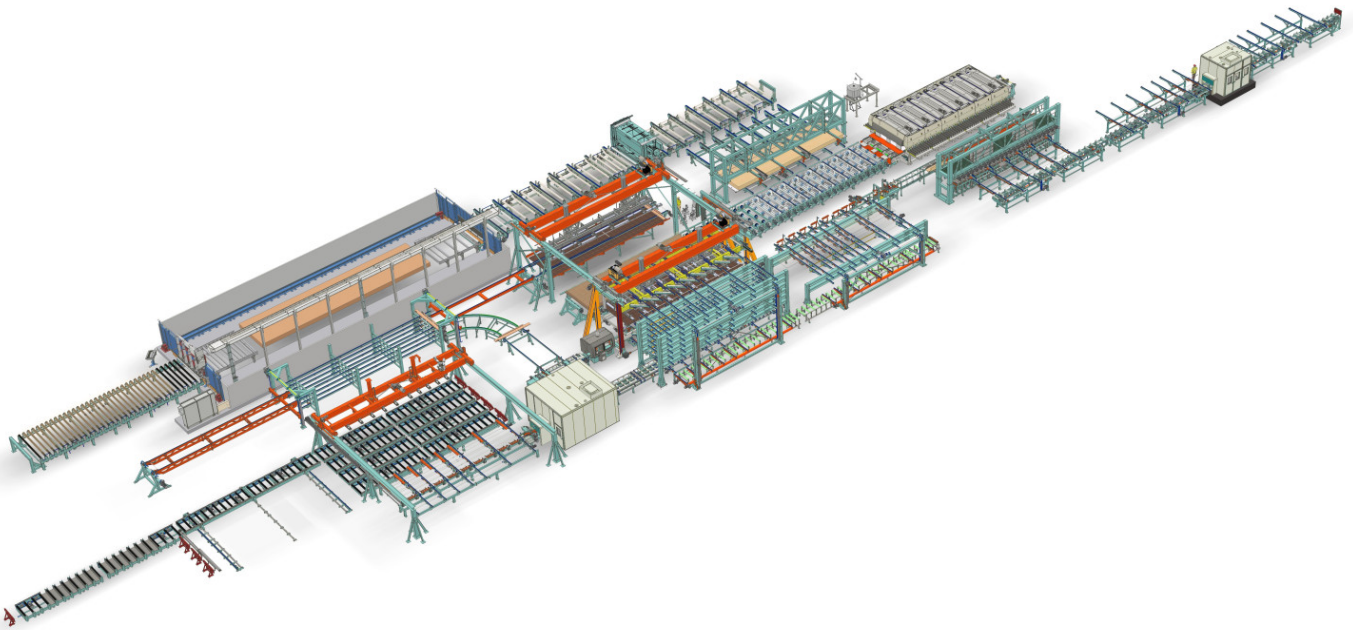

The layout is symbolic

Complete CLT Facility

1. Package handling with de-stacking and slat manipulation
2. Layer transport with buffer zone and infeed
3. Measuring section with sorting and Optifeed loading
4. Superplan pre-planing machine with accessories

Facts

- Panel Size: Up to 14 m x 1.3 m x 0.36 m
- Production Capacity: Over 50,000 m³/year
- Shift Production: Up to 75 m³
- Integrated edge gluing system with Hot Melt Adhesive
- Fast PUR Adhesive with Cold Curing

5. Scanner mechanization, swiper, stacking areas
6. X-cut S400 defect cutting saw
7. Finger jointing machine Kontizink 4000 with glue application
8. Side sweep lug chain, lamella transport, elevators, curing storage with 6 levels
9. Superplan 350-4V lamella planer with water spray system
10. Z-press with Hotmelt assembly gluing and longitudinal saw
11. 8 cross-layer saws with mechanization
12. Cross-layer rotating device, stacking
13. Package manipulation up to XM-Press
14. Vacuum layup station, glue application, and XM-Press
15. Clt de-stacking, mechanization up to patching station
16. Clt conveyors before planing
17. Final planing machine Superles 1300 with chamfering, sanding on top
18. Mechanization to layer cross-cut saw LKS 1300
19. Mechanization for clt, vacuum stacking, package transport
20. Clt storage and package transport

- Short Press Cycle
- High Flexibility in CLT Production
- Integrated Sorting Line with Pre-planing and Scanner

Photo gallery





 Ledinek X-Press product brochure

Related products

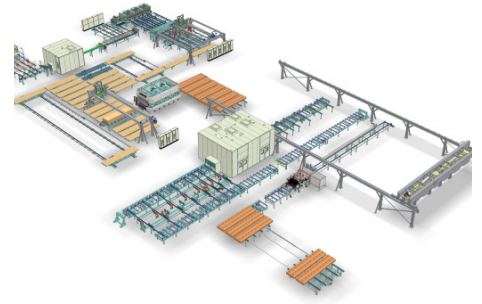
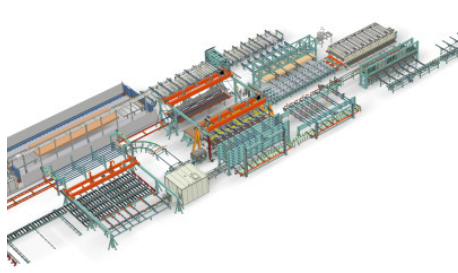
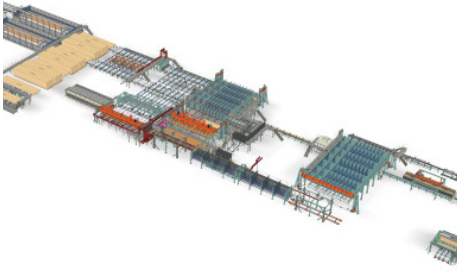

► Volume CLT production line in Sweden

After the first pilot plant for the CLT production, Södra Building Systems made another bolt move and build a big volume plant.

[MORE](#)

► Arboreal: the only Mass Timber Plant in Uruguay and one of the largest in Latin America

The introduction of the Arboreal project in Uruguay marks a significant milestone in the construction and environmental sectors of Latin America. As of early 2022, Uruguay is home to the region's first large mass timber factory

[MORE](#)

► Standard cross laminated timber plant in Portugal

The company Arolla Lda invested in a plant for the production of standard CLT elements with widths of 120 and 125 cm and produces mainly for its own projects and for the local market.

[MORE](#)

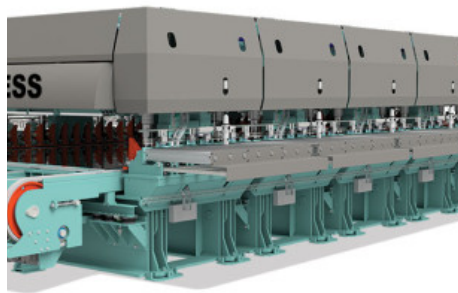
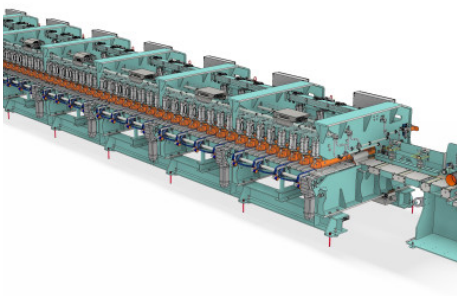

► Z-Press

Edge gluing press with hot-melt for fast assembly bonding of solid wood laminations. Multiple widths or continuous single-layer panels are produced from edge glued laminations. Suitable for the advanced and high capacity CLT production.

► X-Press

Universal High-performance press for large size CLT for single Lamelas assembly and edge glued panels. Suitable also for double or multi press systems using interchangeable aluminium PE coated loading tables.

MORE

MORE