



Complete CLT production solutions

LEDINEK - ENGINEERED TIMBER - CLT PRODUCTION LINE NORWAY

Complete CLT Manufacturing Facility for Splitkon AS in Norway

Company Splitkon AS from Åmot in Norway has invested in new industrial production for large format cross laminated timber panels. The line is in the commissioning stage and will shortly start to supply the domestic market with high quality CLT panels. Company Ledinek got the opportunity to supply a complete Turnkey CLT production. This is the first CLT fabrication line made by Ledinek using MUF glue for the surface bond.

All machines are equipped with newest generation of safety PLC.
A new Turn-key solution for a CLT production out of one hand.

Company: **Splitkon AS**
Facebook: [Splitkonlimtre](#)

Location: Åmot / Norway
Executive Director: Morten L. Johansen
Production Manager: Knut-Arne Johansen
Employees: 50
Species: Spruce
Production capacity: 50,000 m³ / y

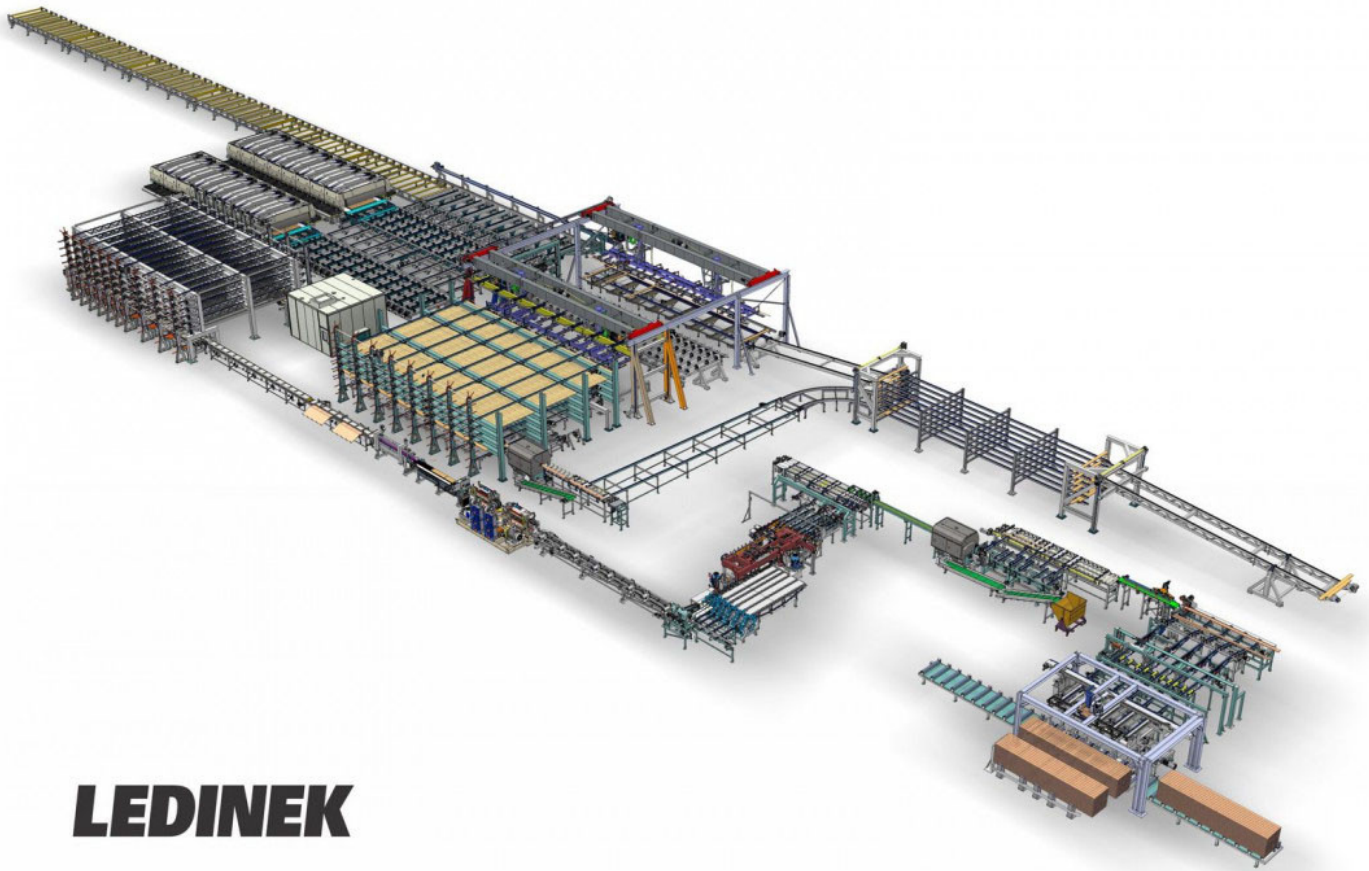

LEDINEK

Turnkey CLT production

1. Vacuum de-stacking of 2 different timber qualities
2. Moisture meter, reject gate
3. MICROTEC Optiside front side scanner to detect the cup on the end of the lumber
4. Luminescent marking reader LUT
5. X-CUT S400 cross-cut saw to remove timber defects
6. Infeed system to finger jointing machine
7. KONTIZINK L-S120 finger jointing line with capacity up to 80 pcs/min; 120 m/min
8. Multi tray curing storage with lug chains
9. Infeed to MULTIPLAN 4V-S200 planer for laminations for high speed and perfect finish
10. Multi tray storage for longitudinal laminations
11. X-CUT S400 cross-cut saw for cross laminations
12. In-feed to Multi tray storage for cross laminations
13. Multi tray storage (6 trays) for cross laminations
14. Vacuum layer assembly unit for Longitudinal Layer
15. Vacuum layer assembly unit for Cross Layer
16. OEST cnc controlled MUF (2 component)

Facts

- Up to 16 m x 3,6 m x 0,36 m panel size
- Production capacity up to 50.000 m³/year
- 100 m³ Shift production
- MUF glue with cold setting
- High flexibility of the CLT production process

- melamine) glue application unit
- 17. Solid fast movable PE coated aluminium table for CLT panel assembly
- 18. X-PRESS 16 - cross laminated timber press with up to 0,8 N/mm² pressure
- 19. X-PRESS 16 m x 3,5 m x 0,36 m
- 20. Longitudinal CLT panel push off unit with outfeed conveyor

Photo gallery





Video

 [Ledinek X-Press product brochure](#)

Related products

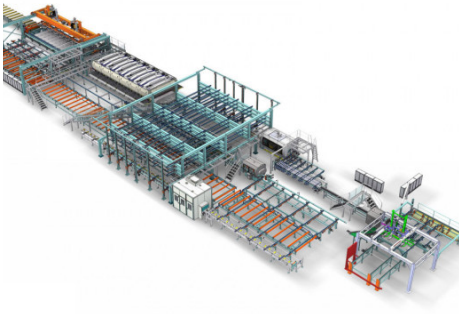

▶ **Pilot CLT production line in Sweden**

Company Södra Wood invested into a pilot plant for CLT production. The pilot plant supports the Södra team create a marketing and production strategy.

MORE

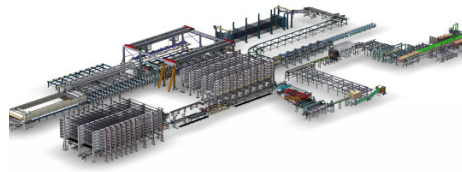

▶ **CLT production line France**

S.A.S. Piveteau Bois from Sainte Florence has invested in a new industrial production for large format cross laminated timber panels.

MORE

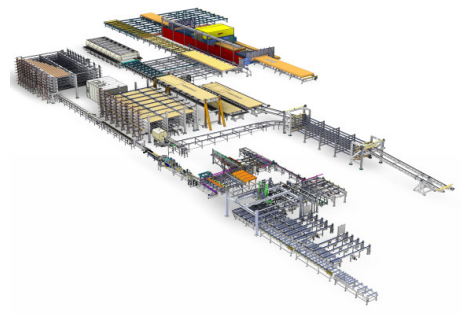

▶ **CLT production line Australia**

First complete CLT production from one supplier in Australia at XLAM We got the opportunity to supply a CLT production Turnkey solution.

MORE

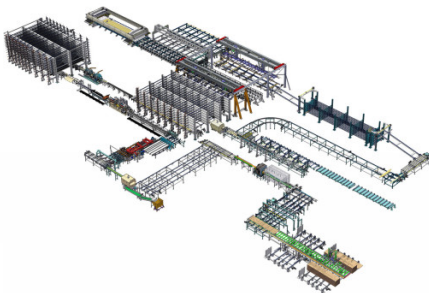

▶ **CLT production line Japan**

First complete CLT production from one supplier in Japan at Cypress Sunadaya Co., Ltd. We got the opportunity to supply a CLT production Turnkey solution.

MORE

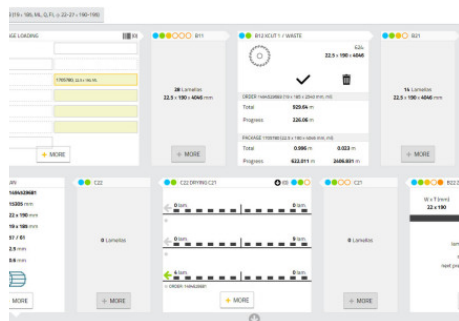

▶ **X-Lam Manager**

Easy to use PC based process control and visualisation system for the complete CLT production line. Comprehensive visualization and editing possibilities of orders for the production of cross laminated timber

MORE

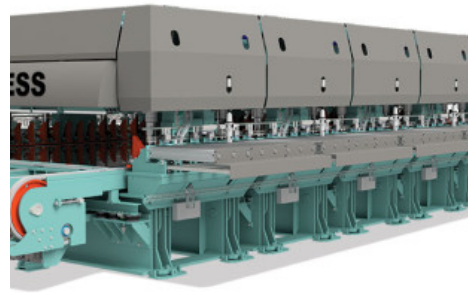

▶ **X-Press**

Cross laminated timber press CLT Press XPress for excellent quality products

MORE